

# COMBINED NEEDLE ROLLER BEARINGS

WITH AXIAL BALL BEARINGS WITH INNER RINGS

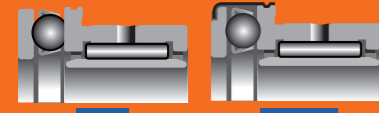

NKXI

NKXI.Z



NKXI



NKXI.Z

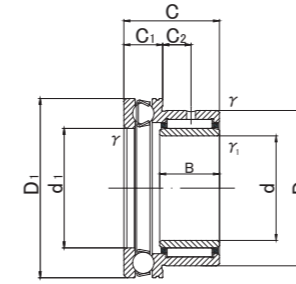

NKXI

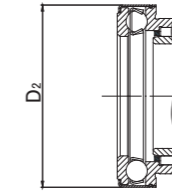

NKXI.Z

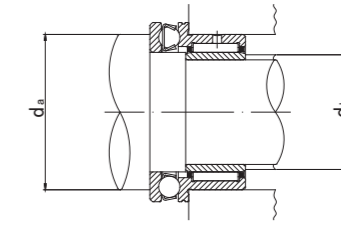

## NKXI, NKXI.Z TYPE

Shaft diameter (mm)	Designation		Dimensions (mm)										Standard mounting dimensions (mm)		Basic dynamic load rating		Basic static load rating		Limiting speed *	Mass	Usable bearing designation		
	Open type	With dust cover															rpm	g (approx.)			OUTER RING	INNER RING	
	Grease pre-packed in thrust section		d	D	D1	D2	B	C	C1	C2	r <sub>s</sub> min	r <sub>s1</sub> min	d1	da MIN	db	Cr N							Cor N
7	NKXI 7	—	7 <sub>0</sub>	19	24	—	16	23	9	6.5	0.3	0.3	10	18	9	8 200	10 000	9 200	14 000	9 500	41	NKX10	IR71016
	—	NKXI 7Z	7 <sub>-0.008</sub>	19	—	25	16	23	9	6.5	0.3	0.3	10	18	9	8 200	10 000	9 200	14 000	9 500	42.5	NKX10Z	IR71016
9	NKXI 9	—	9 <sub>0</sub>	21	26	—	16	23	9	6.5	0.3	0.3	12	20	11	9 200	10 300	11 200	15 400	9 200	46.5	NKX12	IR91216
	—	NKXI 9Z	9 <sub>-0.008</sub>	21	—	27	16	23	9	6.5	0.3	0.3	12	20	11	9 200	10 300	11 200	15 400	9 200	48	NKX12Z	IR91216
12	NKXI 12	—	12 <sub>0</sub>	24	28	—	16	23	9	6.5	0.3	0.3	15	23	14	12 400	10 500	14 900	16 800	8 800	51.8	NKX15	IR121516
	—	NKXI 12Z	12 <sub>-0.008</sub>	24	—	29	16	23	9	6.5	0.3	0.3	15	23	14	12 400	10 500	14 900	16 800	8 800	53.3	NKX15Z	IR121516
14	NKXI 14	—	14 <sub>0</sub>	26	30	—	17	25	9	8	0.3	0.3	17	25	16	12 800	10 800	16 300	18 200	8 500	61.5	NKX17	IR141717
	—	NKXI 14Z	14 <sub>-0.008</sub>	26	—	31	17	25	9	8	0.3	0.3	17	25	16	12 800	10 800	16 300	18 200	8 500	63	NKX17Z	IR141717
17	NKXI 17	—	17 <sub>0</sub>	30	35	—	20	30	10	10.5	0.3	0.3	20	29	19	17 600	14 200	25 400	24 700	7 500	97	NKX20	IR172020
	—	NKXI 17Z	17 <sub>-0.008</sub>	30	—	36	20	30	10	10.5	0.3	0.3	20	29	19	17 600	14 200	25 400	24 700	7 500	99.5	NKX20Z	IR172020
20	NKXI 20	—	20 <sub>0</sub>	37	42	—	20	30	11	9.5	0.6	0.3	25	35	24	20 000	19 600	32 200	37 300	6 500	151.5	NKX25	IR202520
	—	NKXI 20Z	20 <sub>-0.010</sub>	37	—	43	20	30	11	9.5	0.6	0.3	25	35	24	20 000	19 600	32 200	37 300	6 500	154.5	NKX25Z	IR202520
25	NKXI 25	—	25 <sub>0</sub>	42	47	—	20	30	11	9.5	0.6	0.3	30	40	29	25 100	20 400	40 100	42 200	6 200	174.5	NKX30	IR253020
	—	NKXI 25Z	25 <sub>-0.010</sub>	42	—	48	20	30	11	9.5	0.6	0.3	30	40	29	25 100	20 400	40 100	42 200	6 200	178	NKX30Z	IR253020
30	NKXI 30	—	30 <sub>0</sub>	47	52	—	20	30	12	9	0.6	0.3	35	45	34	27 000	20 400	46 200	44 700	5 600	201.5	NKX35	IR303520
	—	NKXI 30Z	30 <sub>-0.010</sub>	47	—	53	20	30	12	9	0.6	0.3	35	45	34	27 000	20 400	46 200	44 700	5 600	206	NKX35Z	IR303520
35	NKXI 35	—	35 <sub>0</sub>	52	60	—	20	32	13	10	0.6	0.3	40	52	39	29 400	26 900	54 100	62 900	5 000	260	NKX40	IR354020
	—	NKXI 35Z	35 <sub>-0.012</sub>	52	—	61	20	32	13	10	0.6	0.3	40	52	39	29 400	26 900	54 100	62 900	5 000	266	NKX40Z	IR354020
40	NKXI 40	—	40 <sub>0</sub>	58	65	—	20	32	14	9	0.6	0.3	45	57	44	31 100	27 900	60 100	69 200	4 600	302	NKX45	IR404520
	—	NKXI 40Z	40 <sub>-0.012</sub>	58	—	66.5	20	32	14	9	0.6	0.3	45	57	44	31 100	27 900	60 100	69 200	4 600	315.5	NKX45Z	IR404520
45	NKXI 45	—	45 <sub>0</sub>	62	70	—	25	35	14	10	0.6	0.6	50	62	49	43 000	28 700	85 200	75 400	4 500	348	NKX50	IR455025
	—	NKXI 45Z	45 <sub>-0.012</sub>	62	—	71.5	25	35	14	10	0.6	0.6	50	62	49	43 000	28 700	85 200	75 400	4 500	362.5	NKX50Z	IR455025
50	NKXI 50	—	50 <sub>0</sub>	72	85	—	25	40	17	12	1	1	60	75	59	47 500	41 400	103 000	113 000	3 700	606	NKX60	IR506025
	—	NKXI 50Z	50 <sub>-0.012</sub>	72	—	86.5	25	40	17	12	1	1	60	75	59	47 500	41 400	103 000	113 000	3 700	628.5	NKX60Z	IR506025
60	NKXI 60	—	60 <sub>0</sub>	85	95	—	25	40	18	11	1	1	70	85	68	55 500	43 100	120 600	127 000	3 400	772	NKX70	IR607025
	—	NKXI 60Z	60 <sub>-0.015</sub>	85	—	96.5	25	40	18	11	1	1	70	85	68	55 500	43 100	120 600	127 000	3 400	796	NKX70Z	IR607025

\* Suitable for oil lubrication. In case of grease lubrication, down to 70% of this value.